

PROPOSED MINOR SUBDIVISION AT 514 RIVERSIDE AVENUE BLOCK 117 - LOT 44.01 TOWNSHIP OF LYNDHURST BERGEN COUNTY, NEW JERSEY

OWNER & ADDRESS REPORT

LYNDHURST 514 RIVERSIDE AVENUE CERTIFIED LIST OF OWNERS
117 - 44.01

BLOCK	LOT	QUAL	CLA	PROPERTY OWNER	PROPERTY LOCATION
116	1.07	2	2	LANGL, GREG & BARBARA 26 PAGE AVE LYNDHURST, N.J.	26 PAGE AVE
116	1.08	2	2	ROBINSON, ELAINE A 501 RIVERSIDE AVENUE LYNDHURST, N.J.	501 RIVERSIDE AVE
116	1.09	2	2	L3C PROPERTY HOLDINGS LLC 505 RIVERSIDE AVENUE LYNDHURST, N.J.	505 RIVERSIDE AVE
116	1.10	2	2	WISZOMATY, PAMEL & ELZBIETA 509 RIVERSIDE AVENUE RUTHERFORD, NJ	509 RIVERSIDE AVE
116	2.01	4A	4A	CARLA DEVELOPMENT CORP. 525 RIVERSIDE AVENUE LYNDHURST, N.J.	525 RIVERSIDE AVE
117	1.1	C001A	2	BUZINSKI, STANLEY & SOPHIE 44 JORDAN AVENUE WALLINGTON, NJ	500 RIVERSIDE AVE
117	1.1	C001B	2	SHANG, WENJING 500 RIVERSIDE AVENUE # 18 LYNDHURST, NJ	500 RIVERSIDE AVE
117	1.1	C001C	2	PEREZ, JOSE S & VAZQUEZ, LIZETTE 500 RIVERSIDE AVE #10 LYNDHURST, NJ	500 RIVERSIDE AVE
117	1.1	C001D	2	NEP, ANDREW J 500 RIVERSIDE AVE UNIT 10 LYNDHURST, NJ	500 RIVERSIDE AVE
117	1.1	C001E	2	KESNER, MICHELLE A 500 RIVERSIDE DR #1E LYNDHURST, NJ	500 RIVERSIDE AVE
117	1.1	C002A	2	THALAKING, SREETANK V (LINA) 500 RIVERSIDE AVENUE #2A LYNDHURST, NJ	500 RIVERSIDE AVE
117	1.1	C002B	2	HEISER, ROBERT W & JOHAN 500 RIVERSIDE AVE APT 20 LYNDHURST, NJ	500 RIVERSIDE AVE
117	1.1	C002C	2	CHAHINE, MIRA KHALLI 500 RIVERSIDE AVE APT 20 LYNDHURST, NJ	500 RIVERSIDE AVE
117	1.1	C002D	2	YASSKY, THOMAS W. & SHEARER LANE WYVE, NJ	500 RIVERSIDE AVE
117	1.1	C002E	2	SUTTON, GREGORY 500 RIVERSIDE AVE UNIT 20 LYNDHURST, NJ	500 RIVERSIDE AVENUE
117	2	2	2	CUCO, RONALD LYNDHURST, NJ	112 PAGE AVE
117	3	2	2	CAPRASSO, MARTIN 116 PAGE AVE LYNDHURST, NJ	116 PAGE AVE
117	4	2	2	NEWBY, WILLIAM J. & EVA MARIE 120 PAGE AVE LYNDHURST, N.J.	120 PAGE AVE
117	5	2	2	VUCCOLO, MICHAEL 122 PAGE AVE LYNDHURST, NJ	122 PAGE AVE

OWNER & ADDRESS REPORT

LYNDHURST 514 RIVERSIDE AVENUE CERTIFIED LIST OF OWNERS
117 - 44.01

BLOCK	LOT	QUAL	CLA	PROPERTY OWNER	PROPERTY LOCATION
117	33.07	2	2	RIVAS, JOHN & MARIE, WILIS 516 ANTHONY CT LYNDHURST, NJ	516 ANTHONY COURT
117	33.08	2	2	CARDILLO, ROSE MARY 516 ANTHONY COURT LYNDHURST, NJ	516 ANTHONY COURT
117	33.09	2	2	MC DERMOTT, KAREN 522 ANTHONY COURT LYNDHURST, NJ	522 ANTHONY COURT
117	33.09	2	2	LIN, BAO H 527 ANTHONY COURT LYNDHURST, NJ	527 ANTHONY COURT
117	34	2	2	FREDA, ANGELA 121 KINGSLAND AVENUE LYNDHURST, NJ	121 KINGSLAND AVE
117	36	2	2	FREDA, ANGELA 121 KINGSLAND AVENUE LYNDHURST, NJ	121 KINGSLAND AVE
117	37.01	2	2	POSEIDON LTD. 540 RIVERSIDE AVENUE LYNDHURST, N.J.	540 RIVERSIDE AVE
117	40.01	4A	4A	POSEIDON LTD 540 RIVERSIDE AVE LYNDHURST, N.J.	540 RIVERSIDE AVE
117	41	4B	4B	POSEIDON PARTNERSHIP 540 RIVERSIDE AVE LYNDHURST, N.J.	540 RIVERSIDE AVE
117	42	4A	4A	M.W.D.S. I.L.L.C. 528 RIVERSIDE AVENUE LYNDHURST, NJ	528 RIVERSIDE AVE
117	43	1	1	WATSON, MICHAEL 518 RIVERSIDE AVE LYNDHURST, NJ	518 RIVERSIDE AVE
117	44.02	2	2	GIUNTA, MARK & ANK MARIE 514 ANTHONY CT LYNDHURST, NJ	514 ANTHONY COURT

The following is a list of utility companies and state agencies, if applicable; need to be notify of Planning or Zoning Board applications by the applicant.

Registered List of Utility Companies for Lyndhurst

Electric Company	Public Service (PSE&G)
Gas Company	Public Service (PSE&G)
Water Company	Passaic Valley Water
Sewers	Passaic Valley Sewage Commission
Cable TV	Comcast Cablevision
Fire Department	Volunteer (Township of Lyndhurst)
Ambulance	Volunteer (Township of Lyndhurst)
Township of Lyndhurst	367 Valley Brook Avenue Lyndhurst, NJ 07071
Passaic Valley Water	1525 Main Street Clifton, NJ 07015
Comcast Cablevision	800 Rahwah Ave. Union, NJ 07087
Passaic Valley Sewage	600 Wilson Ave. Newark, NJ 07105
PSE&G	325 County Ave. Secaucus, NJ 07094
Passaic River Coalition	246 Madisonville Road Basking Ridge, NJ 07920
New Jersey Meadowlands Commission	One DeKorte Plaza Lyndhurst, NJ 07071
New Jersey Transit	1 Penn Plaza East Newark, NJ 07105
Port Authority of NY & NJ	225 Park Avenue South New York, NY 10003
Bergen County Planning Board	One Bergen County Plaza, 4 th Floor Hackensack, NJ 07601
Commissioner of Transportation	Department of Transportation P.O. Box 600 Trenton, NJ 08625-0600
State Planning Commission	Department of Community Affairs P.O. Box 800 Trenton, NJ 08625-0800

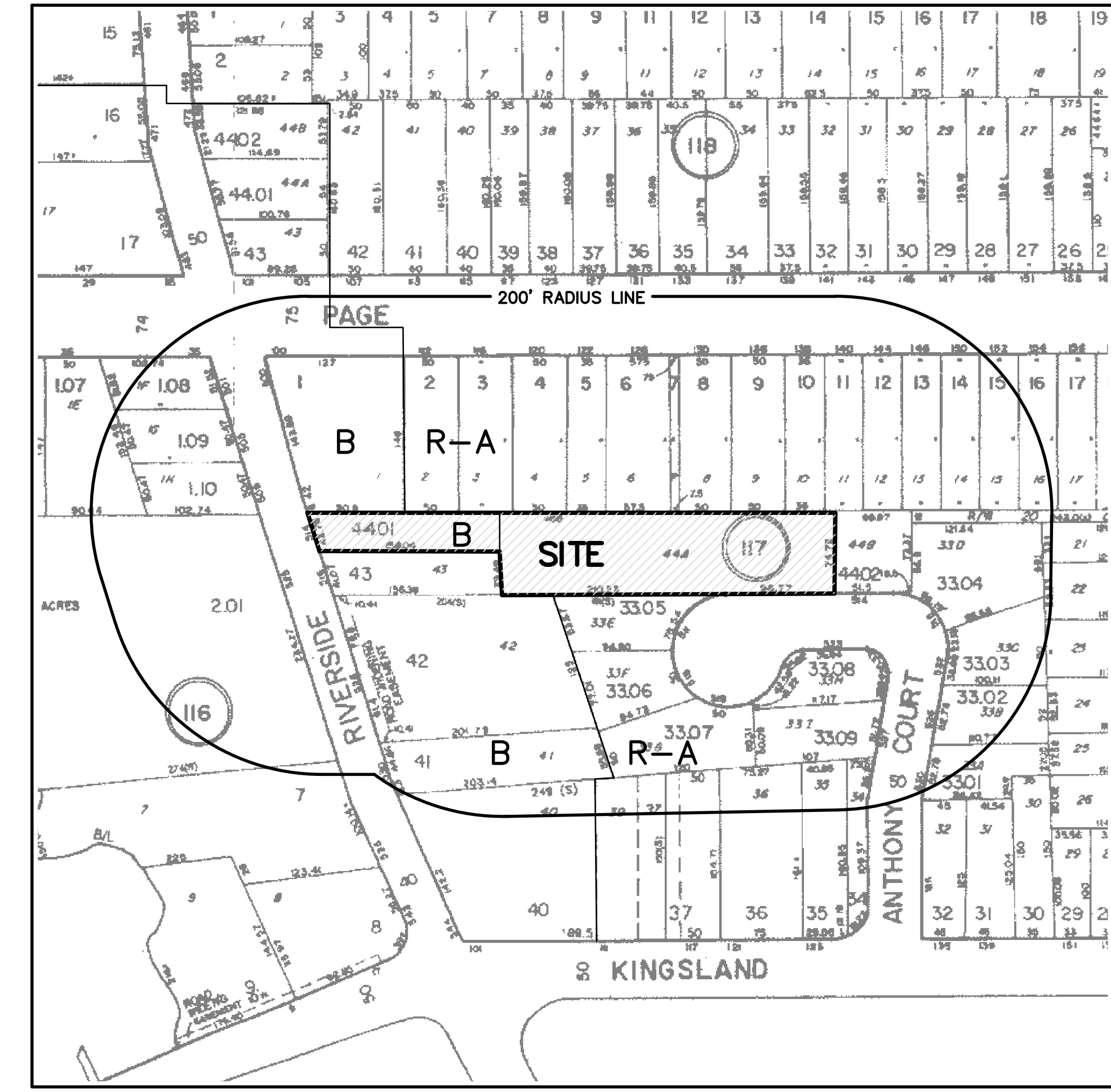

KEY MAP
SCALE: 1" = 100'

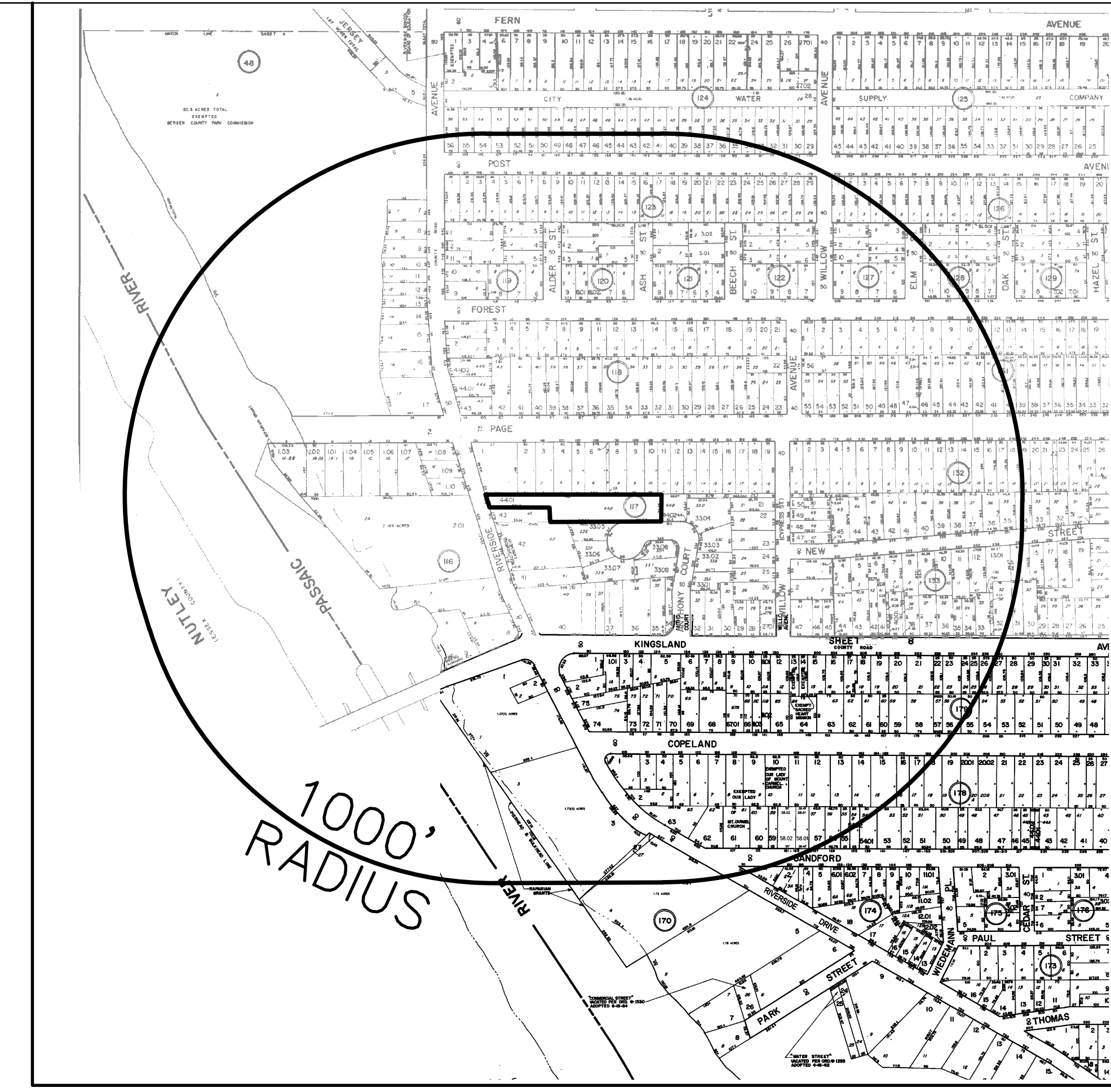

1000' RADIUS MAP
SCALE: 1" = 300'

INDEX	
TITLE SHEET	SP-1
TOPOGRAPHIC AND BOUNDARY SURVEY	SP-2
MINOR SUBDIVISION PLAN	SP-3

APPROVED BY THE PLANNING BOARD

CHAIRPERSON _____ DATE _____

SECRETARY _____ DATE _____

OWNER: _____

APPLICANT: _____

ENGINEER:
OSTERKORN ENGINEERING ASSOCIATES
121 GODWIN AVENUE
WYCKOFF, NEW JERSEY 07481

OSTERKORN ENGINEERING ASSOCIATES
ENGINEERING-SURVEYING-PLANNING-TEL. 201-848-8190 / FAX. 201-848-0981
121 GODWIN AVENUE, WYCKOFF, N.J. 07481