

Proposed 25  
Unit Multi-Family  
Apartment  
Building

Lyndhurst, NJ

Owner/Applicant

VIRGONA  
+  
VIRGONA  
ARCHITECTS / PLANNERS

125 FIVER ROAD SUITE 201  
EDGEWATER, NEW JERSEY 07020

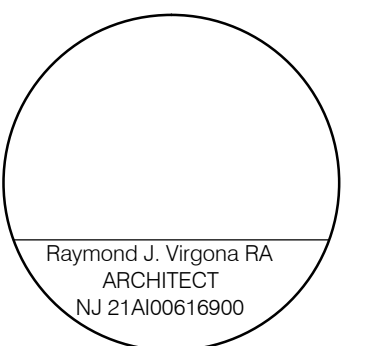

Consultants

This drawing is the property of Virgona & Virgona Architects. Any unauthorized use or reproduction of this drawing without the written consent of the Architect will be prosecuted to the fullest extent allowed under all applicable copyright laws.

Revisions

- 1 9.2.20 REMOVE 2 UNITS  
ADD STOR. CLOS.

Contents  
P L A N

Dwn.	RJV
Chkd.	OFF
Date	1/08/20
Scale	AS NOTED
Job No.	
Dwg. No.	SK-3

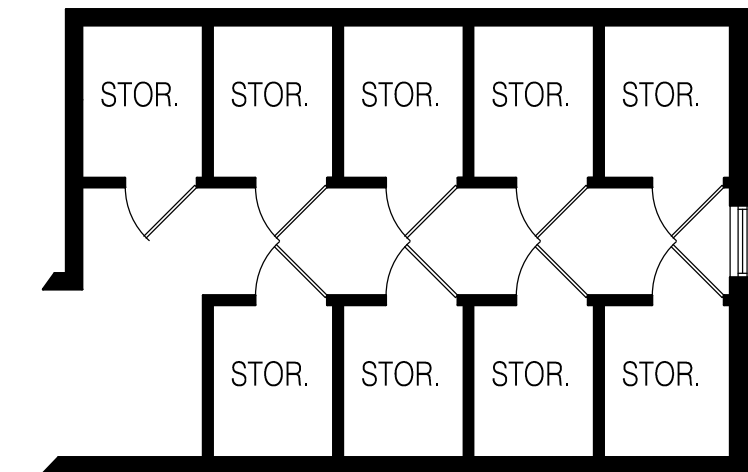

Partial Third Floor Plan

1/8" = 1'-0"

In Place of Fitness Area



Typical Floor Plan (2 + 3)

3/8" = 1'-0"  
14,752 sq. ft.